



PRINCESS 60

PRINCESS 60

With such grace and poise at rest, it's a sheer delight when her sculpted deep-V hull cuts exhilaratingly, and assuredly, through the water. She continues to impress with a vast flybridge appointed with features such as a wetbar, barbecue, soft L-shaped seating and a crafted teak table, just the thing for alfresco dining in a secluded cove.

Avec tant de grâce et d'allure au repos, c'est un pur plaisir quand sa coque sculptée d'un V profond franchit les vagues avec une assurance étonnante. Il fait aussi grande impression, avec son flybridge spacieux parfaitement équipé d'un bar avec évier, d'un barbecue, de sièges confortables disposés en L et d'une table en teck design, idéale pour dîner à la fraîche dans une petite crique isolée.

Die Princess 60 ist in vertäuter Position an sich schon wunderbar anzusehen, doch wenn sich ihr schön geformter, tiefer V-Schiffsrumpf sicher und beeindruckend durch das Wasser schiebt, ist sie eine wahre Augenweide. Auch die breite Flybridge, die u. a. eine Bar, BBQ, weiche Sitzen in L-Form und einen handgearbeiteten Tisch aus Teakholz bietet, ist beeindruckend und der optimale Platz für ein Abendessen im Freien an einem entlegenen Ankerplatz.

Con tanta grazia ed equilibrio a riposo, è un'assoluta delizia quando la sua carena scolpita a V profonda taglia in maniera esaltante e sicura l'acqua. Continua a stupire per il vasto flybridge arredato con vari componenti quali un mobile bar, un barbecue, morbide sedute a L e un tavolo in teak lavorato, l'ideale per cenare all'aperto in una baia isolata.

Истинное наслаждение наблюдать, как это изящное и грациозное судно с глубоким V-образным корпусом уверенно рассекает волны. Яхта Princess 60 является признанным эталоном в своём классе. Она удивляет своим просторным и вместительным флайбриджем, на котором есть полноценный ветбар с барбекю, удобная диванная зона и тиковый стол ручной работы — идеальное место для обеда на свежем воздухе где-нибудь в красивом заливе.





Luxurious attention to detail abounds, with finishes such as hand stitched leather seating and soft touch cabinet linings. The three en suite cabins are no less considered and well-appointed. With acoustic insulation, every space feels completely serene. Something that remains even at sea. And seeing the ocean sweep by through the stateroom hull-side windows is like nothing else.

Les finitions débordent de détails luxueux, avec des sièges en cuir cousus main et des placards garnis de tissu. Les trois cabines avec salles de bains attenantes ont fait l'objet d'autant d'attention et sont parfaitement équipées. Grâce à une isolation acoustique, chaque espace est empreint de sérénité. Et c'est aussi le cas en mer. Voir l'océan défiler au-delà des baies vitrées sur le bordé est une expérience inoubliable.

Bei der Princess 60 wurde sehr viel Wert auf Details gelegt wie handgestickte Ledersitze und Soft-Touch-Gehäusefutter. Auch die drei Ensuite-Kabinen wurden auf die gleiche detaillierte Weise konzipiert und sind gut ausgestattet. Durch die Schalldämmung haben Sie in jedem Raum ein vollständig ruhiges und entspanntes Gefühl, das sogar auf See anhält. Und durch die Fenster im Schiffsrumpf in der Kabine zu sehen, wie der Ozean vorbeigeleitet, ist ein einmaliges Gefühl.

Colpisce inoltre la lussuosa attenzione per i dettagli e le finiture quali sedili in pelle cuciti a mano e il rivestimento dei componenti d'arredo morbidi al tatto. Le tre cabine con servizi privati sono altrettanto attraenti e ben arredate. Grazie all'eccellente isolamento acustico, ogni spazio dà una sensazione di assoluta serenità. Un aspetto che rimane immutato anche in mare aperto. E la vista dell'oceano che scorre dalle finestre sul lato della carena della suite armatoriale è mozzafiato.

Особое внимание к деталям ощущается везде: и в кожаных сиденьях, прошитых вручную, и в мягких стеновых панелях кают. Все три каюты не менее продуманы и хорошо звукоизолированы, что добавляет ощущение комфорта и полной безмятежности. Это чувство не покинет Вас даже в море. Наслаждайтесь прекрасными видами из больших панорамных окон мастер-каюты — непередаваемые впечатления.

PRINCESS 60

PRINCESS 60

ENGLISH

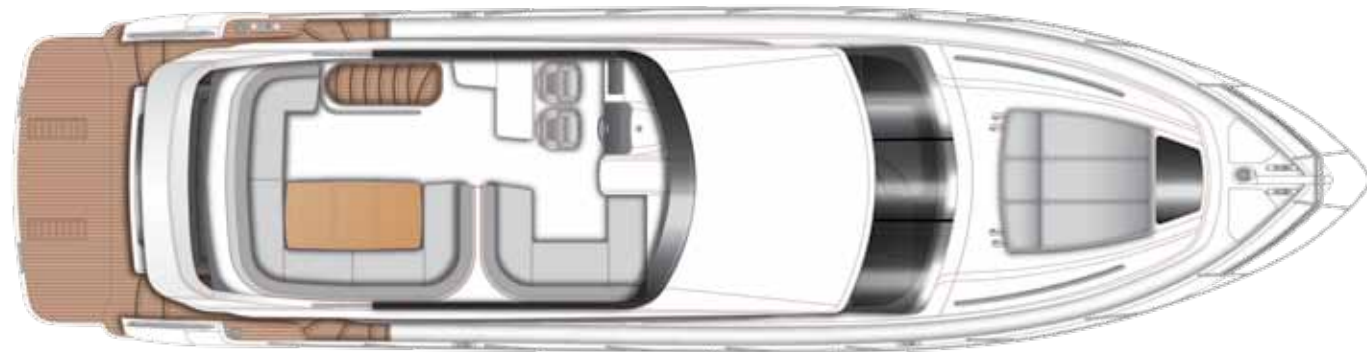

FLYBRIDGE

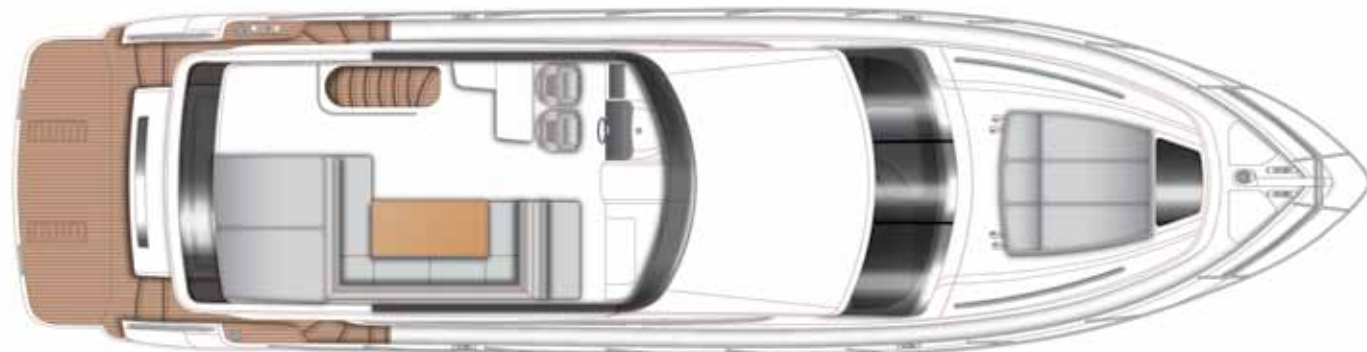

FLYBRIDGE LAYOUT WITH HARDTOP



MAIN DECK

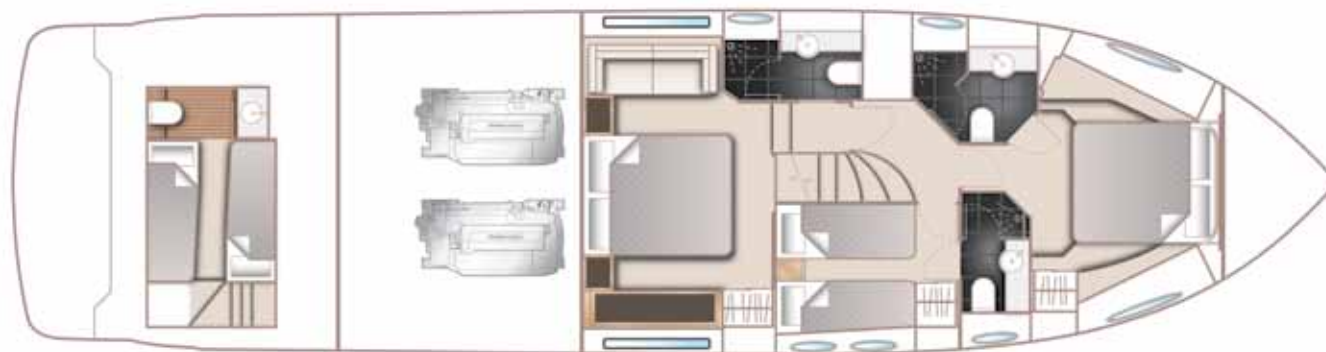

LOWER DECK

PRINCIPAL DIMENSIONS

Length overall (incl. pulpit)	61ft 1in (18.61m)
Length overall (excl. pulpit)	60ft 3in (18.36m)
Beam	15ft 10in (4.83m)
Draft	4ft 2in (1.27m)
Displacement approx.	25,000kg (55,100lbs)*
Fuel capacity	615 gal/739 US gal/2,800l
Water capacity (incl. calorifier)	175 gal/210 US gal/793l

DECK FITTINGS

- Teak-laid transom platform, cockpit deck, flybridge stairway and stairs to side decks
- Self-stowing 25kg/55lbs Delta anchor with 40m of chain
- Reversible electric anchor winch with foredeck, helm position and flybridge controls
- Stainless-steel cleats, fairleads and handrails
- Dual station remote control searchlight

COCKPIT

- U-shaped seating and teak folding table
- Locker housing 240v shore support inlet and cable storage
- Lockable gas strut assisted hatch to engine room
- Transom gate leading to bathing platform with electro-hydraulic raise/lower mechanism, foldaway swimming ladder, hot and cold shower, storage and deck light
- Storage locker for fenders and liferaft
- Cockpit cover

FLYBRIDGE

- Dual station instrumentation, controls and alarm system including VHF/RT, speed and distance log, echo sounder with alarm and autopilot
- U-shaped seating area and teak table with removable centre section
- L-shaped seat (converts to sunbed)
- Radio/iPod/MP3 with waterproof speakers
- Wetbar including sink with electric barbecue and top loading coolbox
- When optional hardtop is selected a sunbed is fitted aft with forward facing seats to starboard side

LOWER HELM POSITION

- Twin helm seats with fore and aft adjustment for helmsman
- Electric opening windows at helm position and port side
- Full engine instrumentation including fuel gauges, exhaust temperature, fuel contamination alarms, rudder position indicator
- Navigation system including colour radar, GPS and chartplotter, VHF/RT, speed and distance log, echo sounder with alarm, autopilot and high speed magnetic compass
- Controls for bow thruster, windscreen wipers, bilge pump and trim tabs (with indicator)
- Chart table with light and chart stowage
- 24v and 220/240v electrical control panels
- 12v outlet
- Red night lighting

DECK SALOON

- Triple opening stainless-steel framed sliding doors to aft cockpit
- U-shaped sofa with coffee table
- Two-seater sofa to port
- Entertainment centre incorporating 48" LED TV with electric raise/lower mechanism and DVD, radio/MP3 system with surround sound system
- Sideboard units with refrigerator, bottle and glass storage and icemaker
- Dining area with U-shaped seating and 2 additional stools (to seat 6 in total)

GALLEY

- 4-zone ceramic hob
- Combination microwave/conventional oven with grill
- Twin stainless-steel sinks with mixer tap
- Full-height fridge/freezer
- Electrically operated sliding glass partition from aft saloon

ACCOMMODATION

- All cabins and bathrooms feature opening portholes
- All cabins feature 220/240v power points
- All mattresses pocket sprung (excluding crew)
- All bathrooms feature full shower stalls, electric freshwater toilets, extractor fan and 240v shaver points
- A combination washer/dryer is fitted in the lower lobby

OWNER'S STATEROOM

- Large double bed with drawers below
- Twin bedside tables
- Wardrobe with shelves
- Dressing table
- Sofa
- 40" LED TV
- Stereo radio, DVD, MP3
- Overhead and individual berth lights
- En suite bathroom

FORWARD GUEST CABIN

- Large double bed with drawers below
- Wardrobe with shelves
- Vanity unit
- Storage lockers and drawers
- Deck hatch with fly screen and blind
- Stowage location for dinette stools (2)
- Overhead and individual berth lights
- En suite bathroom with day access

ENGINE OPTIONS - DIESEL

Twin Volvo D13-800 (2 x 800hp)	Speed range: 31-33 knots†
Twin Volvo D13-900 (2 x 900hp)	Speed range: 33-35 knots†

STARBOARD GUEST CABIN

- Two single beds (with the option of powered conversion to double)
- Wardrobe with shelves
- Storage lockers
- Overhead and individual berth lights
- En suite bathroom

OPTIONAL AFT CABIN

- Two single berths with storage below
- Storage lockers
- Overhead and individual berth lights
- Bathroom with toilet, washbasin and shower

INTERIOR FINISH

- Furniture in Rovere Oak with satin or high gloss finish. American Walnut or Alba Oak available as an option.
- Avonite worktops and tiled floors in all guest bathrooms
- Avonite worktop and timber-laid floor in galley
- Choice of high quality carpet and upholstery fabric from extensive range
- Curtains, blinds or sunscreens to all windows and portholes

POWER AND DRIVE SYSTEMS

- 4-bladed propellers in nickel aluminium bronze
- Bow thruster (130kgf/287lbf)
- Power-assisted electro-hydraulic steering with hydraulic back-up system
- Electronic engine and gear shift controls
- Dripless shaft seals
- Engine room extractor fans with electronic time delay

ELECTRICAL SYSTEMS

- **24 Volt:**
- 4 x heavy duty batteries for engine starting
- 4 x heavy duty auxiliary batteries
- 60 amp battery charger charges both banks of batteries via an automatic switch charging system
- Remote battery master switches with controls at main switch panel
- LED lighting throughout

220/240 Volt:

- 9.5kW diesel generator in own sound shield with water cooled specially silenced exhaust
- Earth leakage safety trip, polarity check system, circuit breakers on all circuits
- Power points in all areas

FUEL SYSTEM

- Twin fuel tanks (in NS8 marine grade alloy) with interconnection system giving 615 gal/739 US gal/2,800l capacity
- Fuel fillers on port and starboard side decks
- High capacity duplex fuel filters/water traps with audible and visual fuel contamination warning system
- Remote fuel cocks in cockpit locker
- Fuel gauges at lower helm position

WATER SYSTEM

- 159 gal/191 US gal/720l plus 16 gal/19 US gal/73l hot water calorifier and heated by engines and 240v immersion heater
- Water level gauge
- Deck filler

FIRE EXTINGUISHERS

- Automatic/manual override fire extinguishers in engine room
- Hand-operated fire extinguishers in all cabins, galley and lower helm

BILGE PUMPS

- Automatic electric bilge pumps (6)
- High-capacity manual bilge pump with valve system and suction points in same areas

OTHER ITEMS SUPPLIED AS STANDARD

- Ensign staff
- Fenders (6) and warps (4)
- First aid kit
- Set of manuals
- Quilted bedspreads in all cabins (except optional crew cabin)