



V48

V 48

As is always the case with Princess, personal choice is paramount. And so with the flexible V48 sports yacht, there's the option for an open design with a full-length cockpit and sunroof, or the enclosed deck saloon model, available with the option of a climate controlled interior. Either way, you're assured supreme exhilaration with up to 34 knots at your fingertips.

Comme toujours avec Princess, votre choix personnel est primordial. C'est le cas pour le spacieux et somptueux V48, qui offre l'option d'un plan ouvert, avec cockpit sur toute la longueur et toit ouvrant, ou bien comme modèle avec salon de pont fermé et climatisé. Quel que soit votre choix, vous êtes assuré de vivre des sensations enivrantes, avec jusqu'à 34 nœuds de puissance au bout des doigts.

Wie es immer bei Princess der Fall ist, haben persönliche Vorzüge die Priorität. Dies ist auch bei der geräumigen und noblen V48 der Fall, die zudem optimal ein offenes Deckdesign mit Cockpit über die gesamte Länge und Schiebedach bietet. Oder alternativ das Modell mit überdachtem Salondeck und klimatisiertem Innenraum. Für welches Modell Sie sich auch entscheiden, Sie können davon ausgehen, dass Sie bei bis zu 34 Knoten Geschwindigkeit in den Rausch höchsten Fahrgenusses kommen werden.

E, come sempre accade sugli yacht Princess, la scelta personale è fondamentale. Il lussuoso e spazioso V48 offre la possibilità di un design aperto con pozzetto a lunghezza completa e tetto apribile. In alternativa, è possibile optare per il modello con salone chiuso sul ponte e interni climatizzati. Ad ogni modo, potete stare certi che con 34 nodi a disposizione l'esaltazione suprema sarà a portata di mano.

Для компании Princess личный выбор владельца яхты — вопрос первостепенной важности. Также и со спортивной V48, которая предлагается в открытом исполнении с объединёнными салоном и кокпитом и большим люком в крыше или с закрытым салоном, который позволяет регулировать климат интерьера. Так или иначе, в Ваших руках окажется высшее наслаждение, летающее с максимальной скоростью в 34 узла.





Innovative flexibility continues into the beautiful lower deck saloon which can either be an entertaining space or converted to provide additional berths. There is the added option of specifying this area with an inviting third cabin. The master stateroom is a beautifully appointed sanctuary whilst the forward guest cabin enjoys the option of scissor berths and oval ports.

Le superbe salon du pont inférieur, qui peut être soit un espace de réception, soit une troisième cabine accueillante, est aussi un exemple de flexibilité et d'innovation. La cabine du propriétaire est un sanctuaire magnifiquement aménagé et la cabine avant pour les invités est équipée en option de deux couchettes disposées en biais et de hublots ovales pour que la lumière tienne compagnie à vos invités lors de leur séjour.

Die innovative Flexibilität wird in dem wunderschönen Unterdecksalon fortgeführt, der entweder als ein Unterhaltungsraum oder als eine einladende dritte Kabine genutzt werden kann. Die Master-Kabine ist ein wunderbar ausgestattetes Kleinod, während die vorderen Gäste-Kabinen optionale Scheren-Kojen und ovale Bullaugen haben, durch die das Tageslicht in die Kabinen eindringt.

La flessibilità innovativa continua nel bellissimo salone sul ponte inferiore che può essere uno spazio d'intrattenimento o un'invitante terza cabina. La cabina armatoriale è un santuario splendidamente arredato, mentre la cabina di prua è provvista di letti singoli standard convertibili in matrimoniale e oblò ovali per fare in modo che la luce naturale accompagni gli ospiti durante il loro soggiorno.

Иновационная гибкость продолжается в её роскошном салоне, который может быть прекрасным местом для отдыха или превратиться при желании в третью каюту. Мастер-каюта станет Вашим любимым местом, а гости в передней каюте могут насладиться опцией сдвигаемых кроватей и большими иллюминаторами, обеспечивающими дневной свет на протяжении всего пребывания на борту.



V48

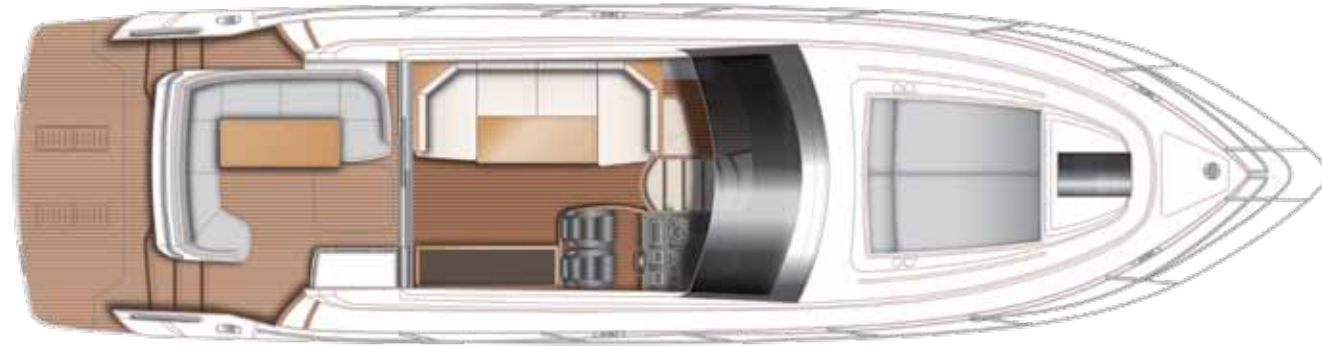

MAIN DECK

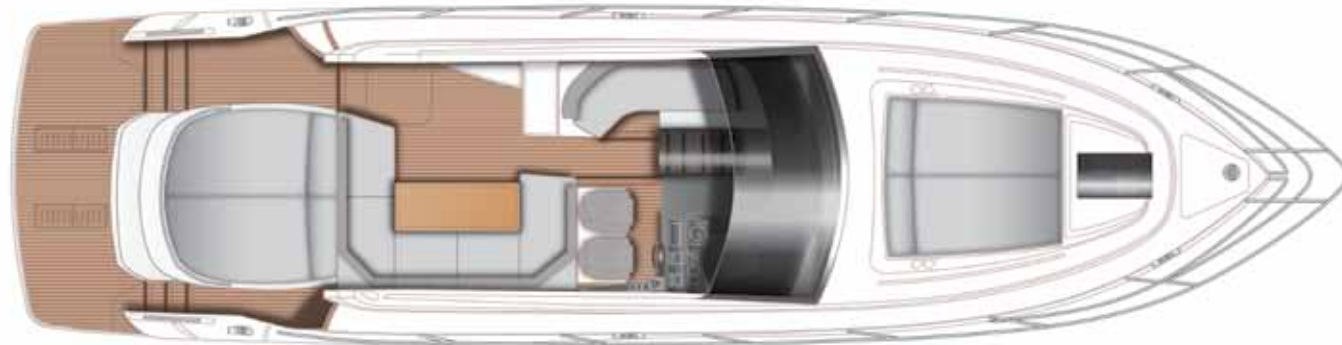

MAIN DECK - OPEN

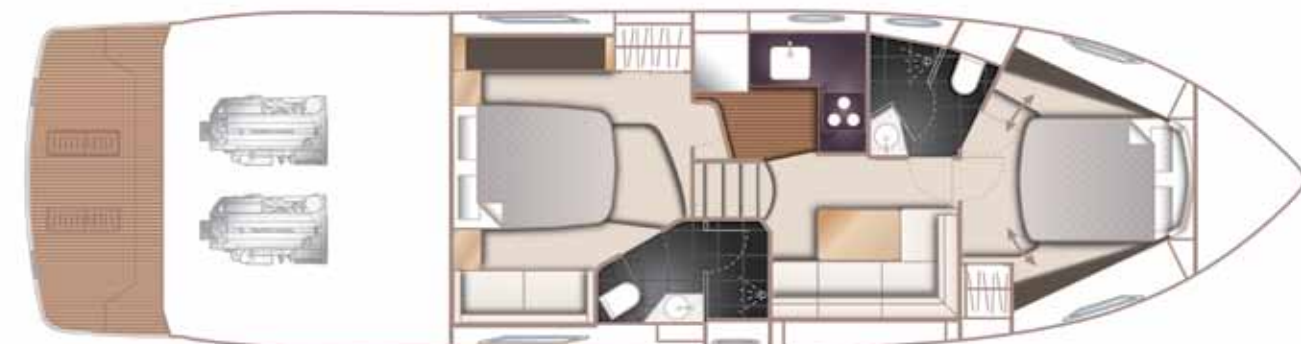

LOWER DECK



LOWER DECK - OPEN

PRINCIPAL DIMENSIONS

V48

Length overall (incl. pulpit)	50ft 10in (15.49m)
Length overall (excl. pulpit)	49ft 11in (15.21m)
Length of hull	46ft 2in (14.07m)
Beam	13ft 6in (4.11m)
Draft	3ft 9in (1.14m)
Displacement approx.	14,200kg (31,300lbs)*
Fuel capacity	291 gal/350 US gal/1,325l
Water capacity (incl. calorifier)	80 gal/96 US gal/364l

V48

ENGLISH

V48 Open

Length overall (incl. pulpit)	51ft 10in (15.8m)
Length overall (excl. pulpit)	50ft 11in (15.52m)
Length of hull	46ft 2in (14.07m)
Beam	13ft 6in (4.11m)
Draft	3ft 9in (1.14m)
Displacement approx.	14,300kg (31,500lbs)*
Fuel capacity	291 gal/350 US gal/1,325l
Water capacity (incl. calorifier)	80 gal/96 US gal/364l

ENGINE OPTIONS - DIESEL

Twin Volvo IPS 600 (2 x 435mhp)	Speed range: 32-34 knots†
---------------------------------	---------------------------

DECK FITTINGS

- Teak-laid transom platform, cockpit deck and stairs to side decks
- Reversible electric anchor winch with foredeck and helm position controls
- Self-stowing 20kg/44lbs Delta anchor with 40m of chain
- Stainless steel cleats, fairleads and handrails
- Remote control searchlight

COCKPIT

- Seating with folding teak table
- Lockable gas strut assisted hatch to engine room
- Transom gate leading to bathing platform with optional electro-hydraulic raise/lower mechanism, foldaway swimming ladder and hot and cold shower
- Lifteraft storage locker
- Locker housing 240v shore support inlet
- Locker with remote fuel cocks
- Cockpit cover
- Transom hatch to stern lazarette
- Storage locker for 2 gas bottles
- The V48 Open also incorporates: electro-hydraulic bathing platform as standard, aft sunpad and tender garage (up to 3.5m), large seating area aft with fixed teak table, electrically operated canvas sun roof, wetbar including sink, coolbox and storage with optional barbecue, L-shaped seating opposite the helm and sliding door to lower accommodation

HELM POSITION

- Twin helm seat with bolster
- Electric opening helmsman's window
- Full engine instrumentation including fuel gauges, joystick control and rudder position indicator
- Navigation system including VHF/RT, speed and distance log, echo sounder with alarm and high speed magnetic compass
- Controls for windscreen wipers, bilge pump, anchor winch and trim tabs (with indicator)
- Chart table
- Remote control searchlight

DECK SALOON

- Triple opening stainless steel framed sliding doors to cockpit
- U-shaped sofa and dining table
- Sideboard unit with glass and bottle storage and refrigerator
- Electric opening roof
- Stereo radio/MP3 with saloon and cockpit speakers
- Timber-laid floor

LOWER SALOON

- Seating area with table (with option of conversion to double berth or third cabin)
- 24v and 220/240v electrical control panels
- Storage lockers
- Stereo radio/MP3 with saloon and cockpit speakers (Open only)

GALLEY

- 3-zone gas hob with flame-failure device (3-zone ceramic hob standard on Open)
- Remote solenoid switch for gas system
- Combination microwave/conventional oven with grill
- Stainless steel sink with monobloc mixer tap
- Full-height fridge/freezer
- Waste bin
- Storage cupboards, drawers and lockers

ACCOMMODATION

- All cabins and bathrooms feature opening portholes
- All cabins feature 220/240v power points
- All mattresses pocket sprung
- All bathrooms feature full shower stalls, electric freshwater toilets, extractor fan and 240v shaver points

OWNER'S STATEROOM

- Large double bed with drawers below
- Wardrobe with shelves
- Sofa
- Storage lockers and drawers
- Overhead and individual berth lights
- En suite bathroom

FORWARD GUEST CABIN

- Large double bed with drawers below (option of scissor berths)
- Wardrobe with shelves
- Storage lockers
- Deck hatch with integrated skylight and blind
- Overhead and individual berth lights
- En suite bathroom with day access

INTERIOR FINISH

- Furniture in Rovere Oak with satin or high gloss finish. American Walnut or Alba Oak available as an option
- Avonite worktops and tiled floors in all guest bathrooms
- Avonite worktop and timber-laid floor in galley
- Choice of high quality carpet and upholstery fabric from extensive range
- Curtains, blinds or sunscreens to all windows and portholes

POWER AND DRIVE SYSTEMS

- Twin Volvo IPS-600 with joystick control
- Volvo active corrosion protection system
- Power-assisted electronic steering system with hydraulic back-up
- Electronic engine and gear shift controls
- Engine room extractor fan

ELECTRICAL SYSTEMS

- **24 Volt:**
 - 4 x heavy-duty batteries for engine starting
 - 4 x heavy-duty auxiliary batteries
 - 40 amp battery charger charging both banks of batteries via automatic switch charging system
 - LED lighting throughout

220/240 Volt:

- 7kW diesel generator in own sound shield with water cooled specially silenced exhaust (Open only)
- Shore support inlet in cockpit locker with storage for cable
- Polarity check system
- Earth leakage safety trip
- Power points to all areas

FUEL SYSTEM

- Twin fuel tanks (in NS8 marine grade alloy) with interconnection system giving 291 gal/350 US gal/1,325l capacity
- Fuel fillers on port and starboard side decks
- High capacity fuel filters/water traps

WATER SYSTEM

- 80 gal/96 US gal/364l plus 11 gal/13 US gal/50l hot water calorifier and heated by engine and 240v immersion heater
- Water level gauge
- Deck filler

FIRE EXTINGUISHERS

- Automatic/manual override fire extinguishers in engine room with manual override
- Hand-operated fire extinguishers (4) in owner's stateroom, guest cabin, galley and deck saloon

BILGE PUMPS

- Automatic electric bilge pumps (3)
- High-capacity manual bilge pump with valve system and suction points in same areas

OTHER ITEMS SUPPLIED AS STANDARD

- Ensign staff
- Fenders (6) and warps (4)
- First aid kit
- Tool kit
- Set of manuals
- Quilted bedspreads in all cabins